



HARI
SHRUSHTI
— THE WONDERFUL LIVING —

Belavali, Badlapur (W).

॥ सृजामः श्रेष्ठं, स्थापयामः नूतनं ॥

We Create Excellence, We Build The New

1 BHK MASTER, 2 BHK
& 3 BHK LUXURIOUS FLAT

Where
Happiness
feels at home

Step Into a space where every morning begins with fresh air, open skies, and peaceful hill views.

A home designed for joyful moments, where families laugh together, children grow freely, and life feels lighter every day.

Surrounded by nature and filled with warmth, this is more than just an apartment. It's your personal retreat, your comfort zone, your forever home in Badlapur.



Badlapur | where nature
welcomes you home

Badlapur is blessed with scenic dams, serene lakes, and refreshing river views that bring nature closer to everyday life. Surrounded by lush greenery and open landscapes, the area offers fresh air, calm mornings, and peaceful evenings. Here, water bodies blend beautifully with nature, creating a soothing environment perfect for relaxed living.

A place where natural beauty and tranquility shape a healthier, happier lifestyle.





A life
shaped
by balance
and
Beauty

Live in a space where
comfort, style, and serenity
come together naturally.
Beautifully crafted homes
that offer quiet elegance,
smart planning,
and a feeling of calm that
stays with you.

1 BHK MASTER,
2 BHK & 3 BHK
LUXURIOUS
FLAT



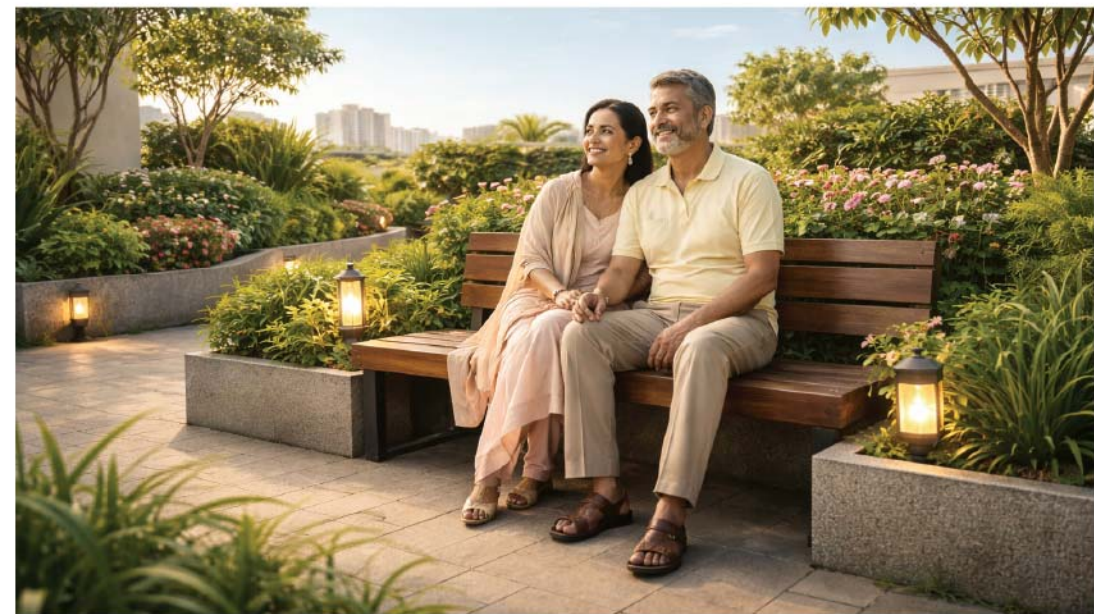

Live Active. Live
Peaceful.
Live Together.

HARI
SHRUSHTI
— THE WONDERFUL LIVING —





Sunsets, *Serenity*
& Social Moments

A beautifully designed rooftop featuring yoga deck, elegant seating lounges and open-sky spaces, perfect for peaceful mornings and memorable sunset evenings.



An Address
Beyond
Expectations



Where Life Stays *Well Connected*

SHOPPING & ENTERTAINMENT

- Patel's R Mart 2.7 km
- Reliance Smart Point 1.3 km

CONNECTIVITY

- Chikhholi Station 2.2 km
- Badlapur Station 2.3 km
- Panvel Highway 1.3 km
- Ambernath-Karjat Highway 1.3 km

RESTAURANTS & HOTELS

- McDonald's 1.3 km
- Pizza Hut 1.3 km
- KFC 1.3 km
- Domino's Pizza 4.0 km
- Hotel Venkey's 1.3 km
- Hotel D-Adda 1.3 km
- Krishna Palace 1.3 km
- Cake Shop 3.3 km

EDUCATIONAL CENTERS

- Fatima High School 0.7 km
- Sunrise International School 1.3 km
- Cinderella English School 0.7 km

HOSPITALS / HEALTH CENTRE

- Dentist 0.7 km
- Pharmacy 0.7 km
- Government Hospital 0.7 km
- Global Hospital 1.3 km
- Apoorva Hospital 3.3 km
- Chikhholi Hospital 3.3 km

OTHER BENEFITS

- Petrol Pump & CNG Pump 1.3 km
- Sports Complex 1.3 km
- Police Station 5.3 km
- Axis Bank 4.0 km
- ICICI Bank 4.0 km
- Lotus Pond 1.3 km



Smart Infrastructure. Better Lifestyle.

Hari Shrushti is perfectly positioned in Badlapur's fast-growing neighborhood, offering strong infrastructure, excellent future connectivity, and a peaceful distance from city congestion — creating the ideal balance of comfort and convenience.



Central Railway Badlapur
(Upcoming 3rd & 4th Line)

Badlapur station is being upgraded to support faster and smoother daily travel. The new railway lines will improve train frequency, reduce crowding, and make commuting more comfortable and reliable.



Upcoming Mumbai Metro Lines 12 & 14

New metro routes will bring quicker connectivity across the Kalyan-Badlapur region. These lines will simplify daily travel, shorten commute times, and connect residents effortlessly to Mumbai's metro network.



Better Roads & Highway Connectivity

With major highways and upcoming corridors, Badlapur is becoming easier to reach than ever before. Seamless road access ensures faster travel to Mumbai, Navi Mumbai, and key commercial destinations.



Navi Mumbai International Airport

The upcoming international airport will significantly boost regional accessibility. Quick road connectivity will allow residents to reach the airport conveniently, saving time on long-distance travel.



Delhi-Mumbai Tunnel Road

This new tunnel route will dramatically cut travel time between Thane, Navi Mumbai, and surrounding areas. Enjoy quicker business trips and smoother daily commutes with reduced traffic congestion.



Mumbai-Ahmedabad Bullet Train

India's high-speed rail project will transform intercity travel. With a nearby station, residents will enjoy faster connections to major cities, making long journeys easier and more efficient.





An Address
Beyond
Expectations

Project Features

- | Stilt +11 story
- | Elegance Entrance Lobby
- | AC Gymnasium
- | Rooftop & Sitting Area
- | Community Hall
- | Temple
- | Walking Track
- | Skating Ring
- | Open Amphitheatre area
- | Children play area with equipment
- | Senior Citizen Sitting Area
- | Garden
- | Firefighting System
- | CCTV surveillance in common area
- | Branded elevator with power backup





TYPICAL FLOOR PLAN
(3RD, TO 7TH, 9TH, TO 11TH. FLOOR)

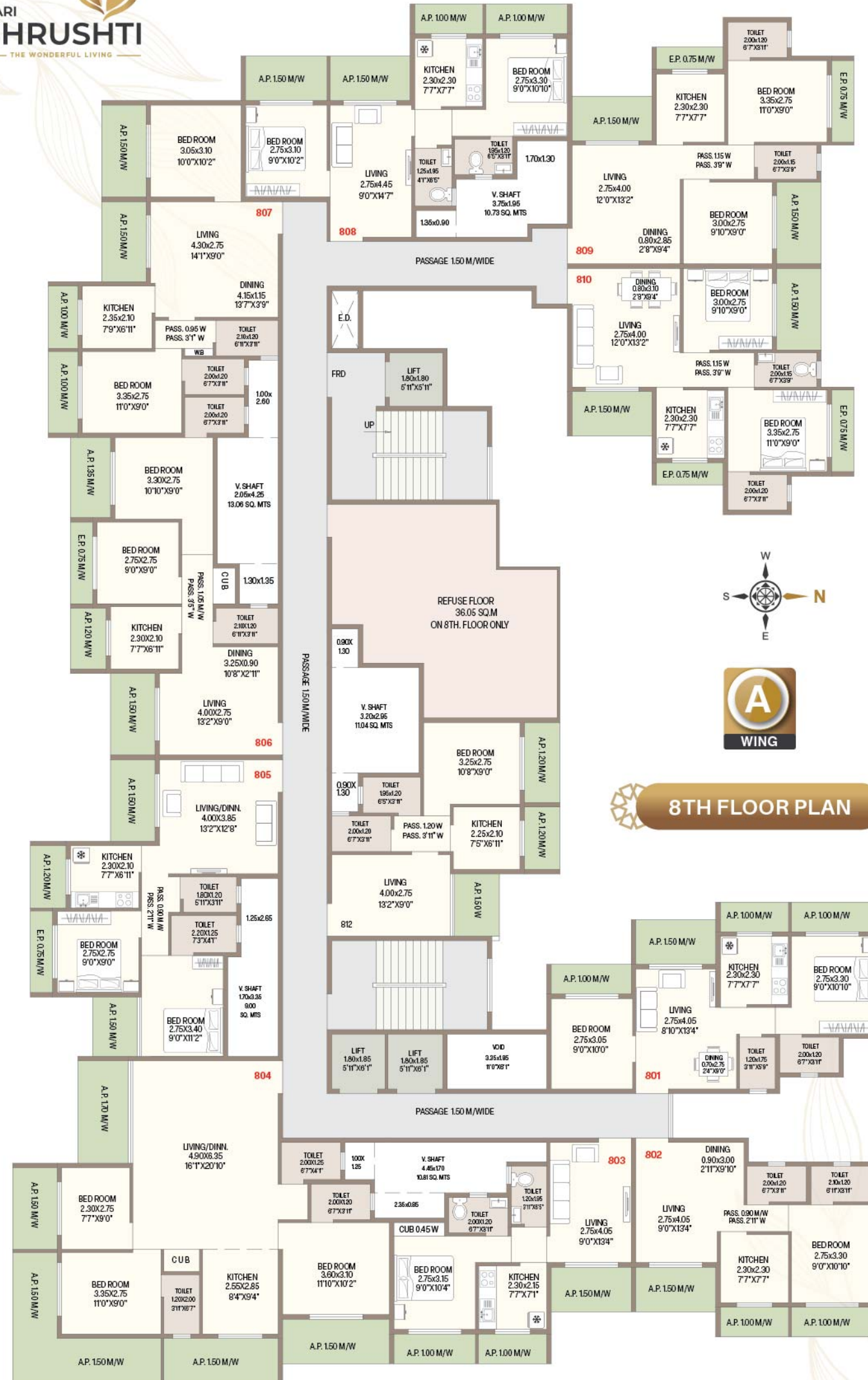

8TH FLOOR PLAN



8TH FLOOR PLAN



TYPICAL FLOOR PLAN
(1ST TO 7TH, 9TH, TO 11TH. FLOOR)



Elevated Living, Everyday *Comfort*

Project Specifications



LIVING & DINING

- » Vitrified flooring in Master Bedroom



KITCHEN

- » Vitrified flooring
- » Granite kitchen platform with S.S. sink
- » Color glazed tiles upto beam level above platform



BEDROOM

- » Vitrified flooring in master and common bedrooms
- » AC point in master bedroom



DOORS

- » Main door and bedroom door with decorative laminate sheets and wooden frame
- » Door for toilet and bathroom



TOILET

- » Designer tiles on dado up to beam bottom
- » Anti-skid ceramic tiles flooring
- » Concealed plumbing with branded fittings
- » Provision for geyser



WINDOWS

- » Aluminium sliding windows



ELECTRICAL

- » Concealed copper wiring of reputed brand with modular switches



PAINTING

- » Premium paint on internal walls
- » Acrylic paint on external walls



ENTRANCE

- » Elegant Entrance Lobby



LIFT

- » Automation Lift of reputed make





MAHA RERA REG. NO. P51700049971
<https://maharera.mahaonline.gov.in>

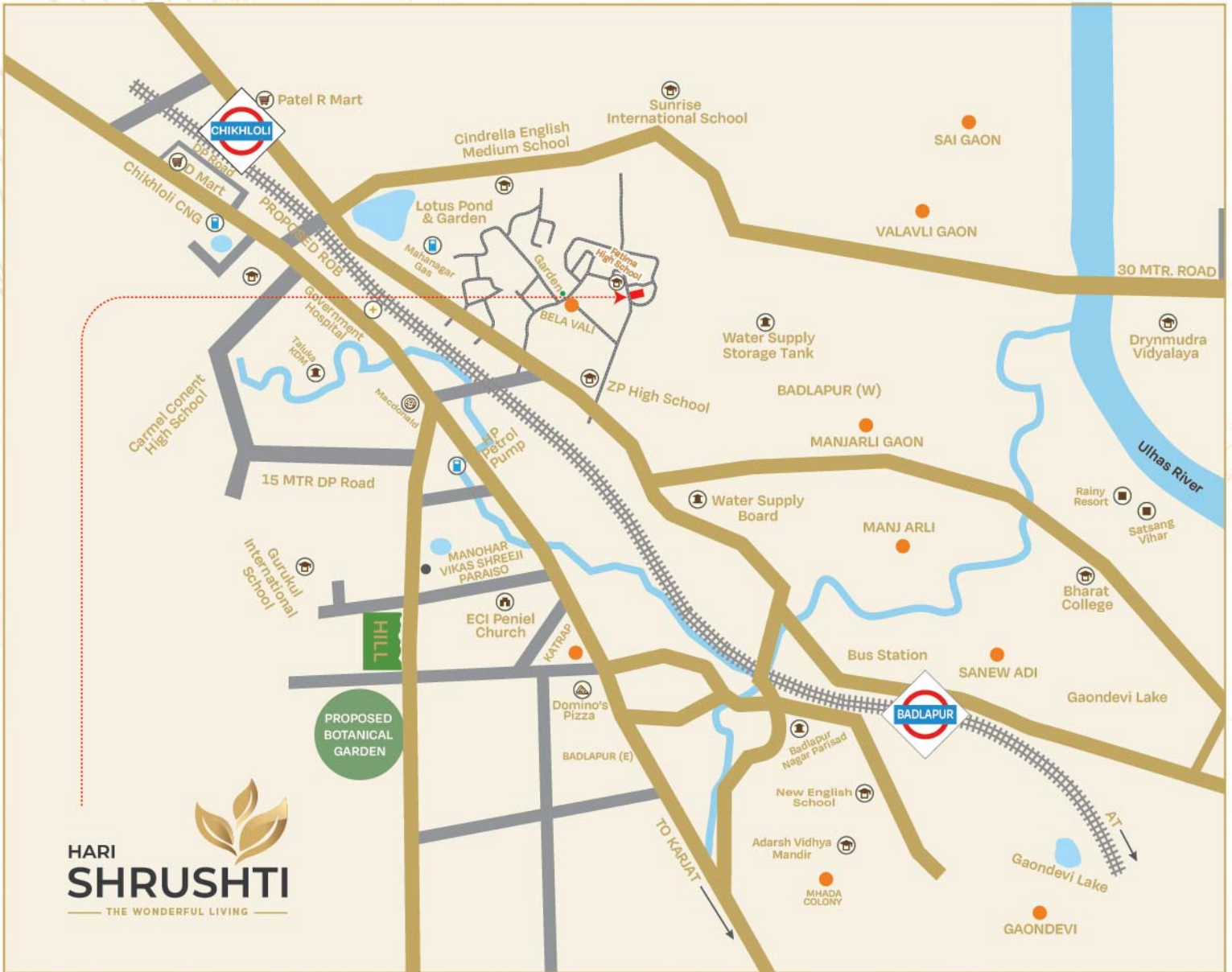

A PROJECT BY:



SHRUSHTI
CREATORS

Site / Office:

SHRUSHTI CREATORS

Survey No. 105/A, H.No. 4/1, Opp. Fatima High School,
 Belavali, Badlapur (W) 421 503.

Email: shrushticreators1529@gmail.com

Contact for Booking: +91 72767 20987

Architect : Raj & Associates | RCC Consultant : Aadhar Engineers

Disclaimer: The plans, specifications, and other details herein are only indicative and subject to the approval of the concerned authorities. The Developer/Owner reserves the right to change any or all of these in the interest of the development, without prior notice or obligation. Artist's impressions are used to illustrate the amenities, specifications, images, and other details and may not represent the actuals. Tolerance of +/- 2% is possible in the unit areas on account of design and construction variance. All brands stated are subject to the final decision of the project architect. Some amenities may be applicable to select apartments only.

Nothing contained in this printed material shall in any manner govern such transaction. The development shall be governed by the terms and conditions of the Agreement for Sale/Lease entered into between the parties and shall not constitute an offer and/or contract of any type between the Developer/Owner and the recipient. Any purchase/lease of this property shall be governed solely by the terms of the executed agreement.